

Western Pygmy Possum

Nesting Box Instructions



Mid Murray
Landcare
SA

The following instructions have been prepared for Mid Murray Landcare SA, by Steve Pearson, based on the design we have deployed as part of our Western Pygmy Possum Project, designed by Don Lester. For more information visit Mid Murray Landcare SA www.midmurraylandcaresa

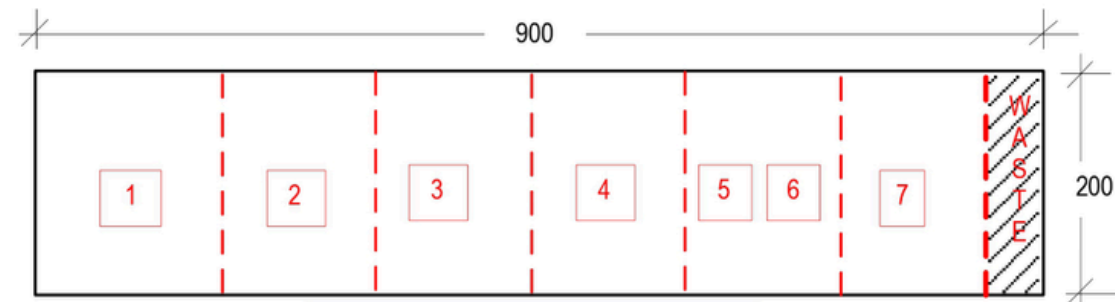

CUT THIS SHEET TO PRODUCE THESE

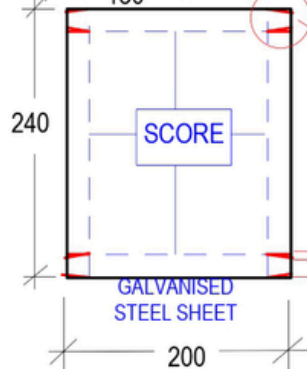
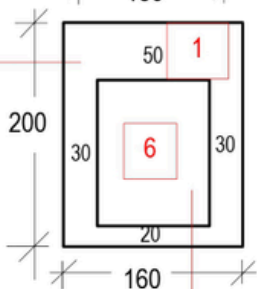
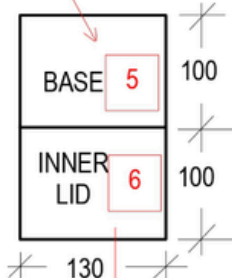
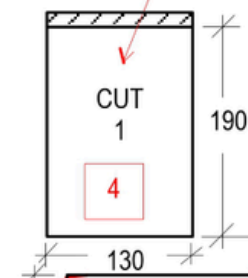
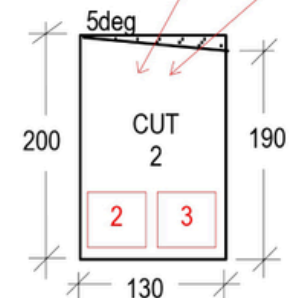
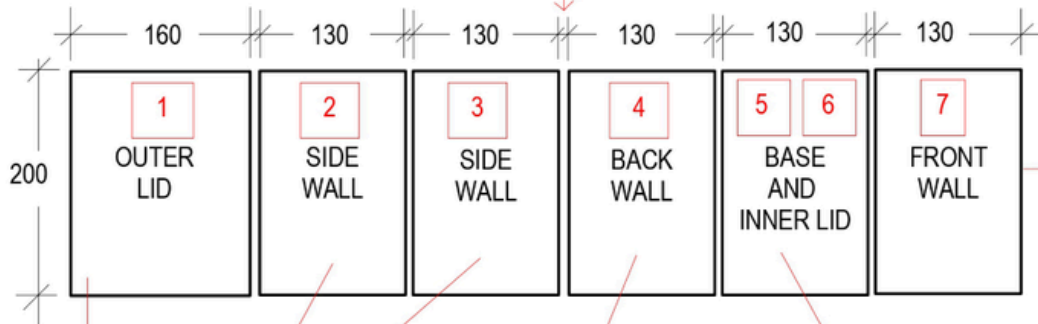

SEE SHEET 3 FOR DETAIL

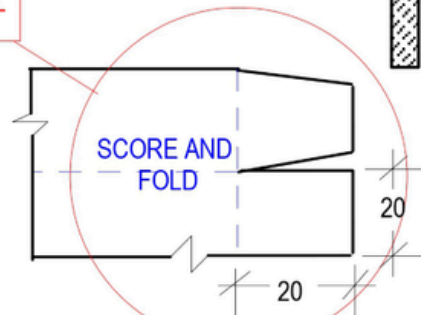

THESE PLANS ARE BASED ON USING 12mm UNTREATED PLYWOOD

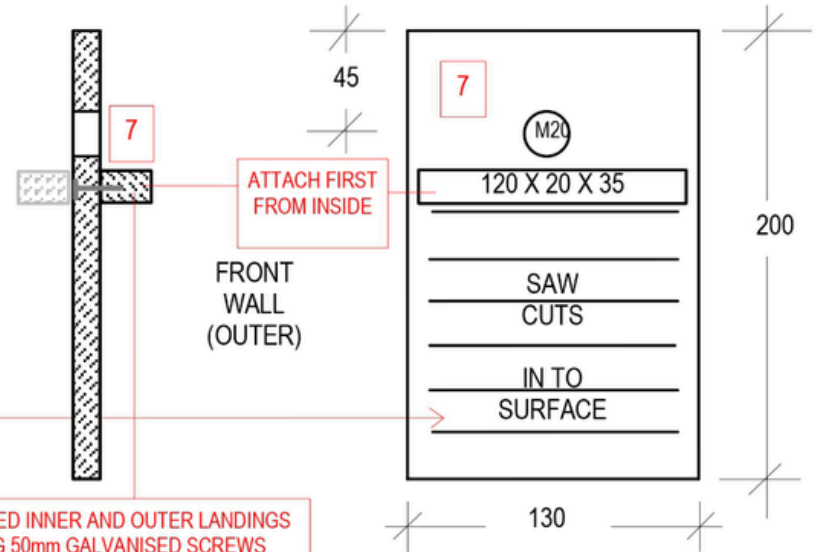

ATTACHED INNER AND OUTER LANDINGS USING 50mm GALVANISED SCREWS

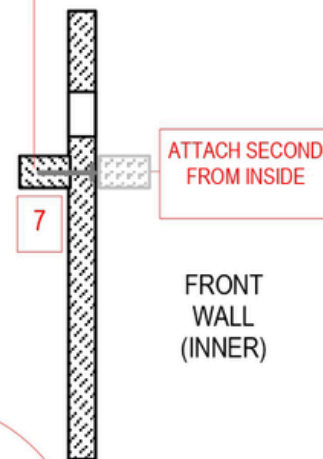

ATTACH SECOND FROM INSIDE

FRONT WALL (INNER)

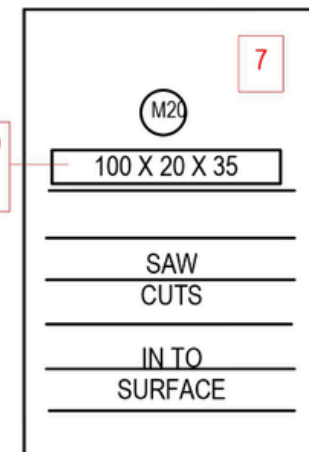

FRONT WALL (OUTER)

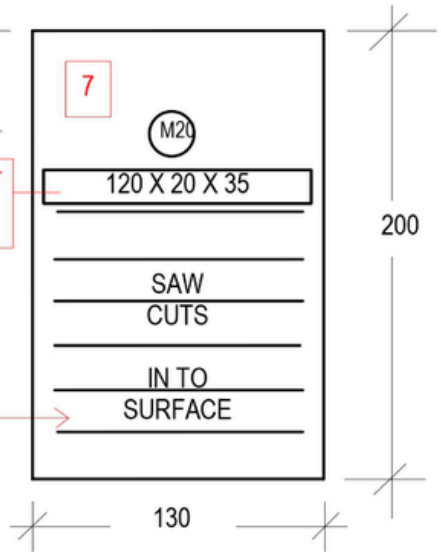

ATTACH FIRST FROM INSIDE

FRONT WALL (OUTER)

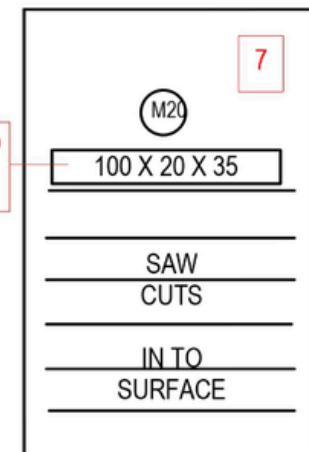
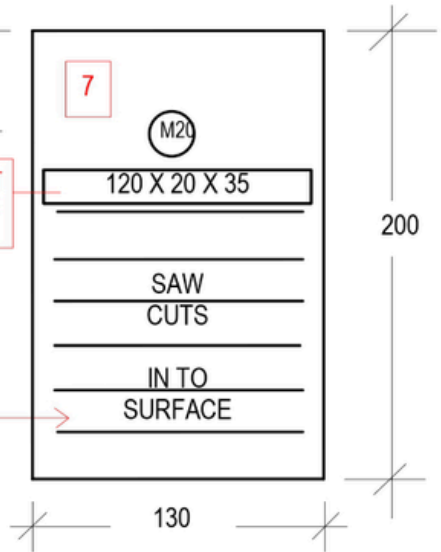

WESTERN PYGMY POSSUM NESTING BOX

DESIGNED BY STEVE PEARSON (C)

SHEET ONE

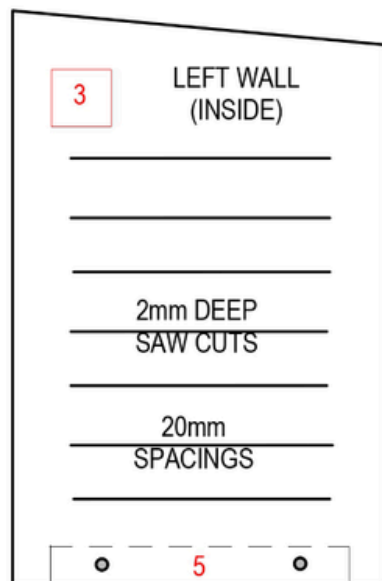

ATTACH

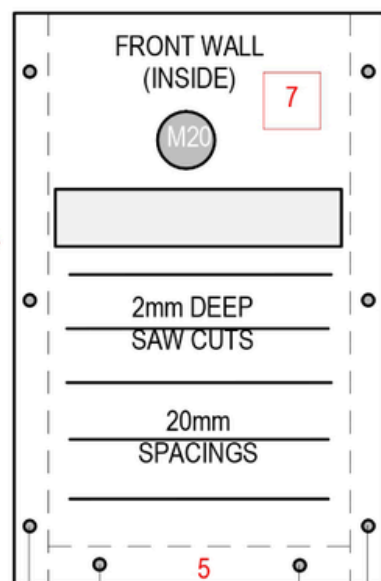

ATTACH

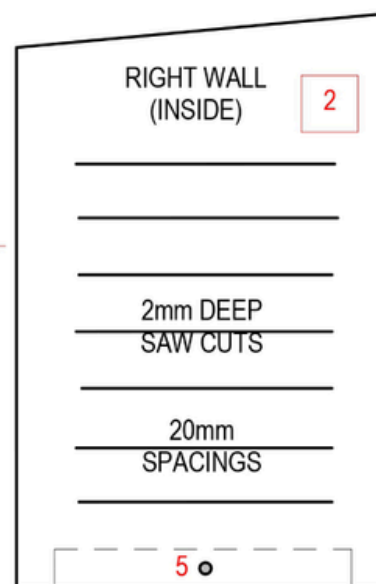

ATTACH

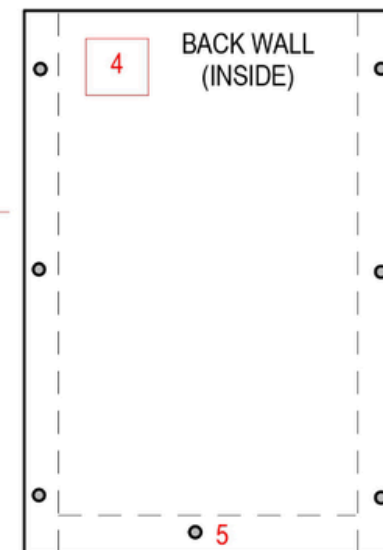

ALL HOLES M4
6mm FROM EDGES

N.B. SIDE WALLS (2 AND 3) FIT
INSIDE FRONT AND BACK WALLS

20mm BUTTON HEAD SCREW
AND RUBBER WASHER

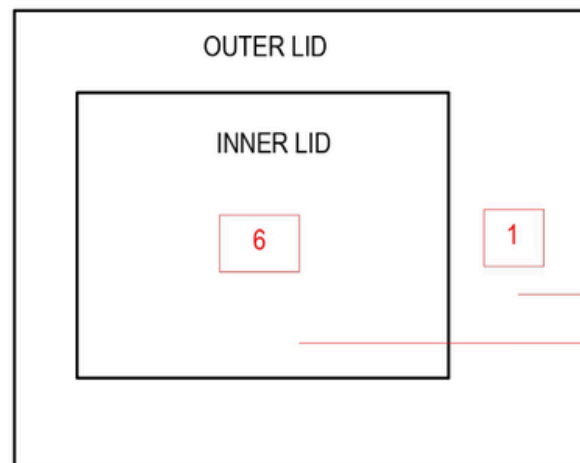

DRILL 3mm HOLES IN TO SIDE WALLS AND BASE
THROUGH 4mm HOLES IN FRONT AND BACK WALLS
PRIOR TO ATTACHING FRONT AND BACK WALLS AND BASE



FOLDED GALVANISED STEEL SHEET FITTED OVER LID AND RIVETED.



STEP 1 - ATTACH SIDE WALLS (2 AND 3) TO BACK WALL (4)
STEP 2 - ATTACH FRONT WALL (7) TO SIDE WALLS.
STEP 3 - INSERT BASE (5) FLUSH AND ATTACH
USING 30mm GALVANISED SCREWS ALL AROUND

SHEET
TWO

WESTERN PYGMY POSSUM
NESTING BOX

DESIGNED BY STEVE PEARSON (C)

GENERAL INSTRUCTIONS AND INFORMATION.

IT IS IMPORTANT TO NOT USE TREATED TIMBERS FOR THIS PROJECT. EXTERIOR PLYWOOD WILL LAST LONGER THAN INTERIOR PLYWOOD.

USING MARINE PLY - ALTHOUGH MORE EXPENSIVE - WILL GIVE YOU A LONGER-LASTING, WATER-PROOF PRODUCT.

THIS PROJECT IS BASED ON THE USE OF 12mm PLYWOOD. THE ONLY POWER TOOLS REQUIRED ARE A TIMBER DROP SAW AND ANGLE GRINDER (OR TIN SNIPS).

A CORDLESS DRILL, 4mm AND 3mm DRILL BITS, A CORDLESS SCREWDRIVER AND 30mm PHILIPS HEAD GALVANISED SCREWS WILL ASSEMBLE THE BOX.

A POP RIVET GUN AND 4.8mm X 10mm RIVETS WILL SECURE THE METAL ROOF COVERING. THE RIVETS WILL ALSO BITE IN TO THE TIMBER LID TO HELP SECURE THE COVERING.

THE ACCESS HOLE TO THE BOX CAN BE CUT USING EITHER A 20mm FORSTNER BIT OR A STEP DRILL BIT. LEDGES AND REAR SPACERS ARE MADE FROM RECYCLED TIMBER.

IT IS POSSIBLE TO MAKE 14 NESTING BOXES FROM ONE 2400 X 1200 SHEET OF PLYWOOD.

REMEMBER TO WEAR EYE AND EAR PROTECTION WHEN USING YOUR POWER TOOLS.

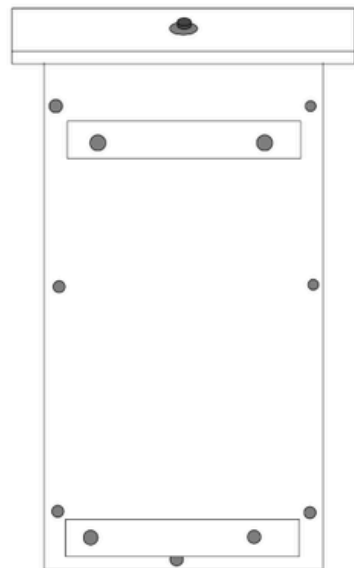

REAR VIEW

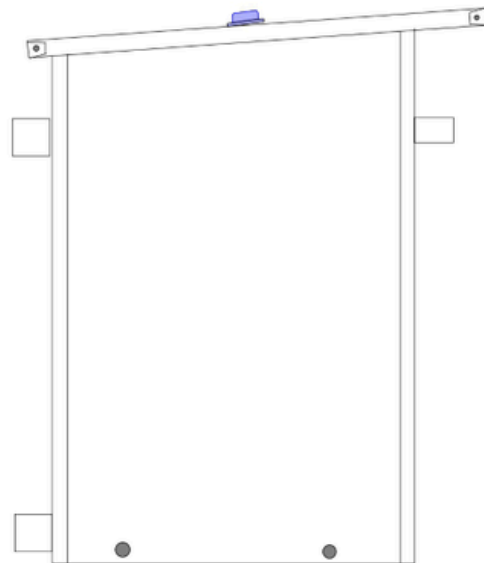

SIDE VIEW



FRONT VIEW



OBLIQUE VIEW

WHAT YOUR FINISHED BOX
SHOULD LOOK LIKE.

**SHEET
FOUR**

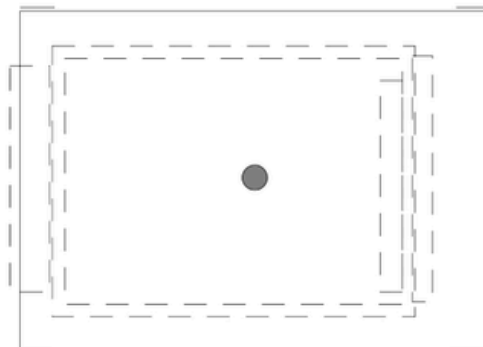

PLAN

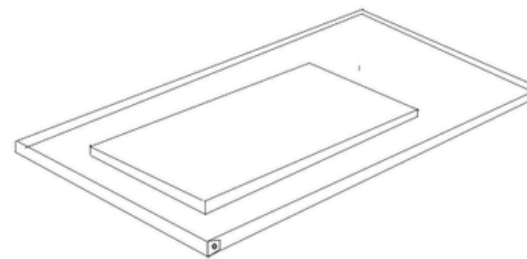

OBLIQUE VIEW OF
UNDERSIDE OF LID

**WESTERN PYGMY POSSUM
NESTING BOX**

DESIGNED BY STEVE PEARSON (C)



What can you do to help the possums?

- Install habitat boxes on your property.
- Control overabundant grazing animals.
- Encourage and protect flowering shrub diversity that the possums use as nectar resources.
- Avoid “cleaning up” too much, as fallen timber provides habitat.
- Keep cats inside all the time, but especially at night.
- Control feral cats and foxes on your property.



Mid Murray
Landcare
SA